



## 23 Goodwood Close, Titchfield Common, Fareham, Hampshire, PO14 4RW.

A pleasant one bedroom unfurnished house which is available for occupation immediately. The layout proves to be extremely popular with a mezzanine double bedroom overlooking the lounge area; the lounge is then open planned with the kitchen. Additionally on the ground floor is a white bathroom suite. Other improvements include gas central heating and more recently the fitting of UPVc double glazing throughout. Outside there is a small area of garden to the front and off road parking. The property is available for long term rental and to arrange a viewing please contact SBK Lettings Department.



**sbk**

[www.sbk4homes.com](http://www.sbk4homes.com)

**01489 570019**

[parkgate@sbk4homes.com](mailto:parkgate@sbk4homes.com)





# 23 Goodwood Close

Titchfield Common, Fareham, PO14 4RW.

£895 PCM

- One Bedroom House
- Pleasant Tucked Away Spot
- Spacious Lounge
- Galleried Bedroom
- White Fitted Bathroom
- UPVC Double Glazing
- Gas Central Heating
- Off Road Parking
- Available Immediately
- Unfurnished Let



23 Goodwood Close, Titchfield Common, Fareham, Hampshire, PO14 4RW. £895 PCM

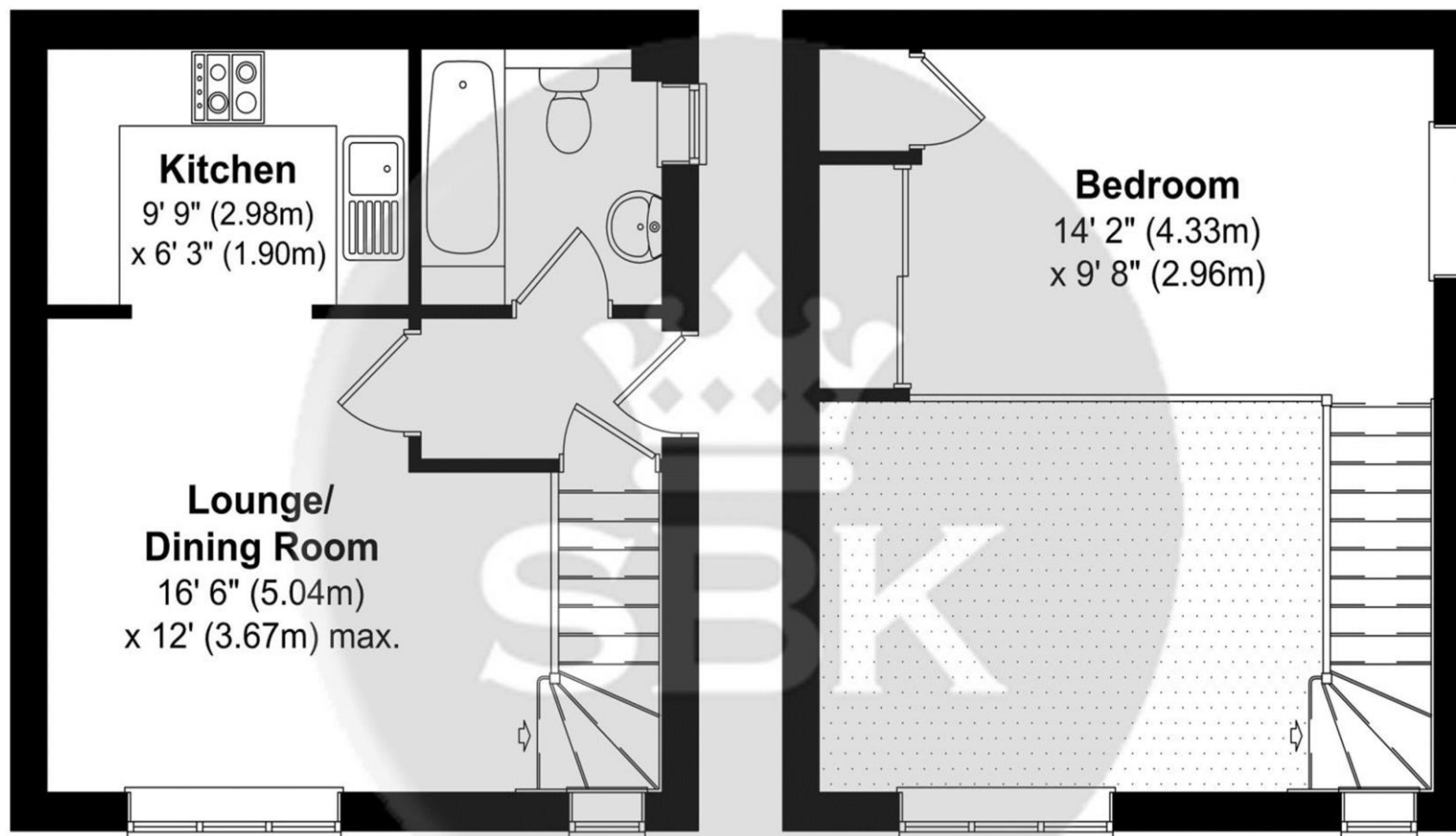

**Approx. Gross Internal Floor Area 463 SQ FT 43 SQ Metres**

Whilst every attempt has been made to ensure the accuracy of the floor plans, measurements of doors, windows and rooms are approximate and no responsibility is taken for any error, omission or mis-statement. These plans are for representation purposes only and should be used as such. The services, systems and appliances listed in this specification have not been tested by SBK Property Consultants and no guarantee as to their operating efficiency can be given.



#### **ADDITIONAL INFORMATION**

##### ***Council Tax Band***

Band B which is payable to Fareham Borough Council. The charge for 2023/24 is £1,534.25.

##### ***Availability Date***

The property is available immediately.

##### ***Length of Let***

Initially offered on either a six or twelve month tenancy but the landlords intentions are for the property to be let on a long term basis.

##### ***Pets***

The landlord for this property has specified that pets are not permitted.

##### ***Energy Performance Certificate***

The rating for the property is D. To obtain a full report of the EPC please contact SBK.

##### ***Parking***

The property has off road parking to the front.



**sbk**  
www.sbk4homes.com  
**01489 570019**  
parkgate@sbk4homes.com

